

Installation Instructions

NEXIS

Nexis control panel (black)
Code 3.035812

Nexis control panel (white)
Code 3.035829



Immergas S.p.A.
42041 Brescello (RE) - Italy
Tel. 0522.689011 immergas.com

Code 1.049781ENG - Rev. ST.009353/001 - 10/25

The manufacturer Immergas S.p.A., hereby declares that the "Nexis zone remote panel" radio appliance complies with directive 2014/53/EU.

For further details on the product CE marking, request a copy of the Declaration of Conformity from the manufacturer, specifying the appliance model and the language of the country

FOREWORD.

The Nexis zone remote panel has been designed to control and regulate the specific generator operating values. Its installation takes a few minutes: the Nexis zone remote panel is connected to the Immergas generator with only 2 cables, through which, it receives and sends the regulation and control commands. Power is supplied in low-voltage 24 Vdc on the available terminals of the Nexis Control Panel and can be supplied by the 230 Vac electric mains by means of a 24 Vdc power supply supplied as per standard.

GENERAL WARNINGS.

This manual was intended for: **the Installer.**

For the warnings, carefully read this instruction sheet supplied as per standard.

Immergas reserves the right to make improvements and changes to details and accessories, excepting the essential features of the model described and illustrated herein.

CLEANING THE CASE.

Use only a dry cloth to clean the cover of the Nexis zone remote panel. Never use abrasive or powder detergents.

1. INSTALLATION.

1.1 Initial check.

Upon the free initial check of the generator, when the appliance is inserted into the system, the Immergas authorised after-sales centre checks the connection to the generator and adjusts operation. The free check just of the Nexis zone remote panel is not envisioned by the Immergas authorised after-sales centre if requested after the generator warranty has initiated.

Attention: installing the Nexis zone remote panel cables is excluded from the free generator checks; it is the responsibility of the installer company.

1.2 Package contents.

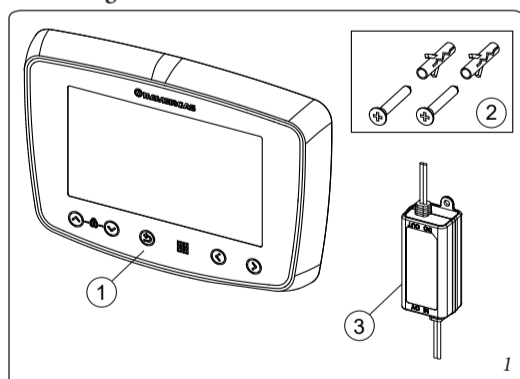

Ref	Description
1	Nexis zone remote panel
2	Kit with expansion plugs and screws for wall mounting of Nexis zone remote panel
3	Power supply 8W - 24V APV 8-24

1.3 Electrical connection.

To install the Nexis control panel, separate the base from the front body prying on the specific recess (Fig. 2).

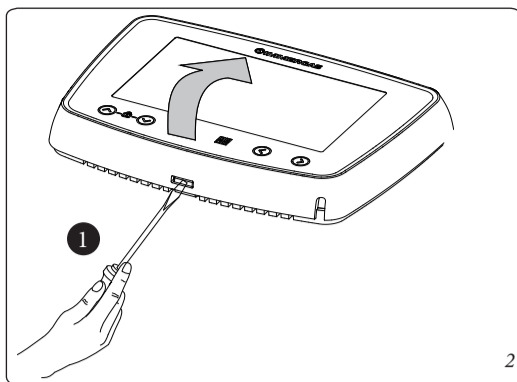

Connect the power cable (Ref.4) and the communication cable (Ref.5) as in Fig. 3. For more details see diagram "Practical wiring diagram of Nexis remote control panel power supply connections" (Fig.6).

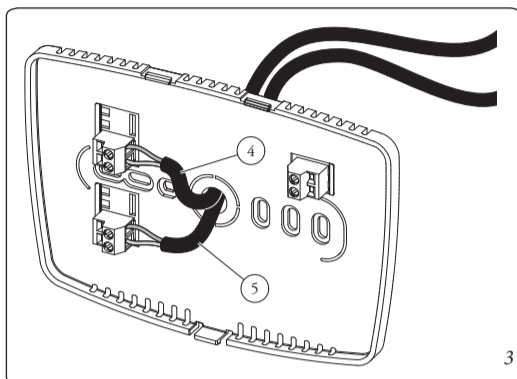

Install the wall base by using the plugs (Fig.4 Ref.2) and screws (Fig.4 Ref.3) included in the supply or on the electric box (type 501, 502 or 503) (Fig. 5). Refit the front body of the device on the wall base.

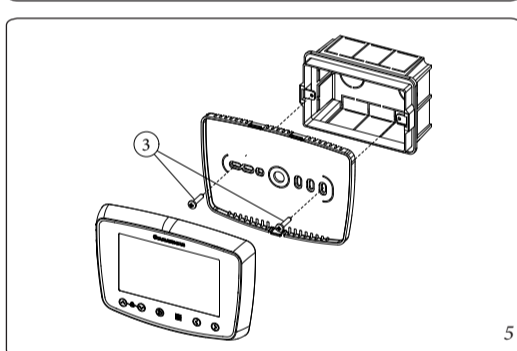
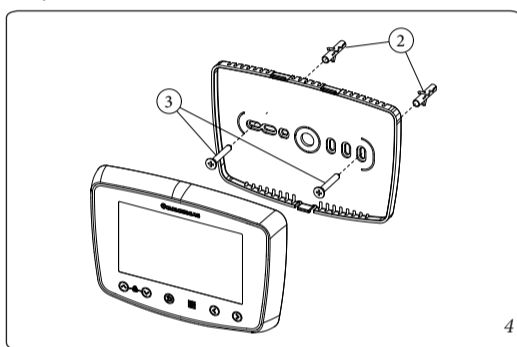

1.4 System configuration.

N.B.: the parameters of the generator must be set appropriately according to the type of generator that Nexis zone remote panel is connected to.

After having powered up the Nexis zone remote panel, wait about 30 seconds before configuration so that communication between the Nexis zone remote panel and the generator has been established.

When switching on for the first time to select the panel language, press to access the 'General Menu'. Use the vertical scroll buttons to scroll through the menu functions and press to access the 'Panel' submenu. Then select 'Language' by scrolling through the menu with the vertical scroll buttons and press the button to change the entry. Then select the desired language by choosing from those proposed using the keys and confirm your choice with .

2. TECHNICAL FEATURES.

- Max absorbed power..... 1W
- Nexis power supply:..... 24 Vdc
- Functioning room temperature:..... 0 - +50°C
- Warehouse temperature:..... -10 - +60°C
- Connection technique:..... 2 polarised wires
- Cable type:..... shielded twisted-pair where necessary
- Max. cable length of generator connection:..... 50 m (with 2x0.75mm² cable) (0.5 mm² min - 1.5 mm² max)
- Insulation class..... III
- Protection class:..... IP20
- Precision indication room temp.:..... ± 0,5°C to 25°C*
- Humidity probe accuracy:..... ± 10%*
- Clock indication diversion:..... ± 15 minutes/year

Note(*): the indications of the room temperature and humidity can be affected by the point of installation of the device (e.g. hot wall, cold wall, height from the ground, etc.).

2.1 Product fiche

In compliance with Regulation 811/2013, the class of the temperature control device is:

Class	Contribution to room central heating seasonal energy efficiency	Description
V	+3%	Nexis zone remote panel
VI	+4%	Nexis zone remote panel coupled to external probe

2.2 Description of Nexis remote control panel couplings to the respective generator.

Generator	Connection diagram	Communication parameters in common with all combinations	Communication parameters related to generator configuration	Generator configuration parameters
Magis M Top	ModBus connections diagram (Fig. 7)	Bitrate : 9600	Device address: 21	A022 = ON (assigned to zone 1)
		Parity : even	Device address: 22	A023 = ON (assigned to zone 2)
		Stop bits : 1	Device address: 23	A024 = ON (assigned to zone 3)

N.B.: for more details on the column 'Generator configuration parameters' refer to the generator booklet.

2.3 Nexis remote control panel main dimensions

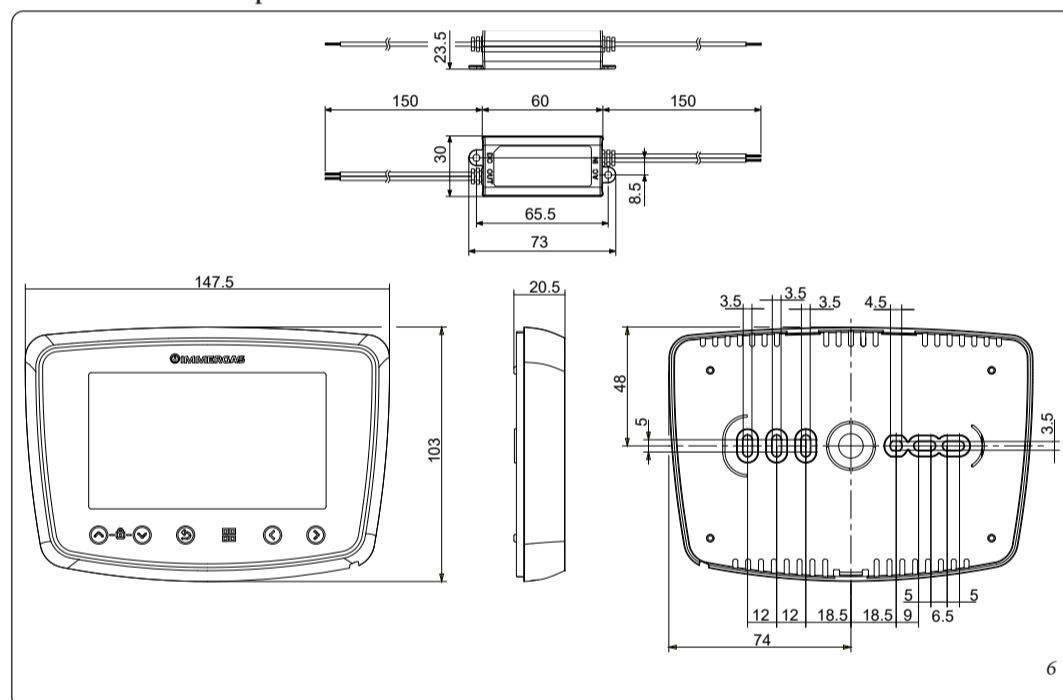

N.B.: measurements expressed in mm.

3. WIRING DIAGRAMS.

3.1 Practical wiring diagram of Nexis remote control panel power supply connections.

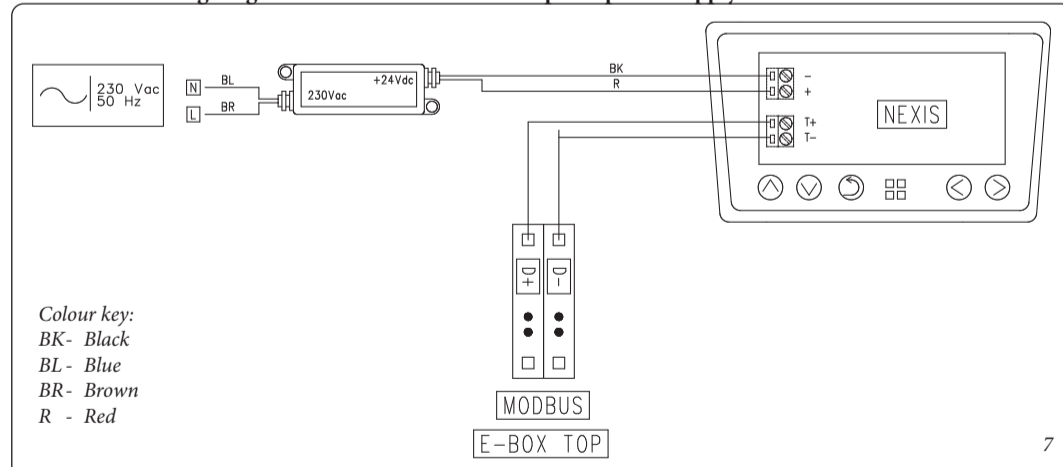

N.B.: for connection to the power supply line (230 Vac), provide a double-insulated electrical cable.