

IE

Instructions and recommendations

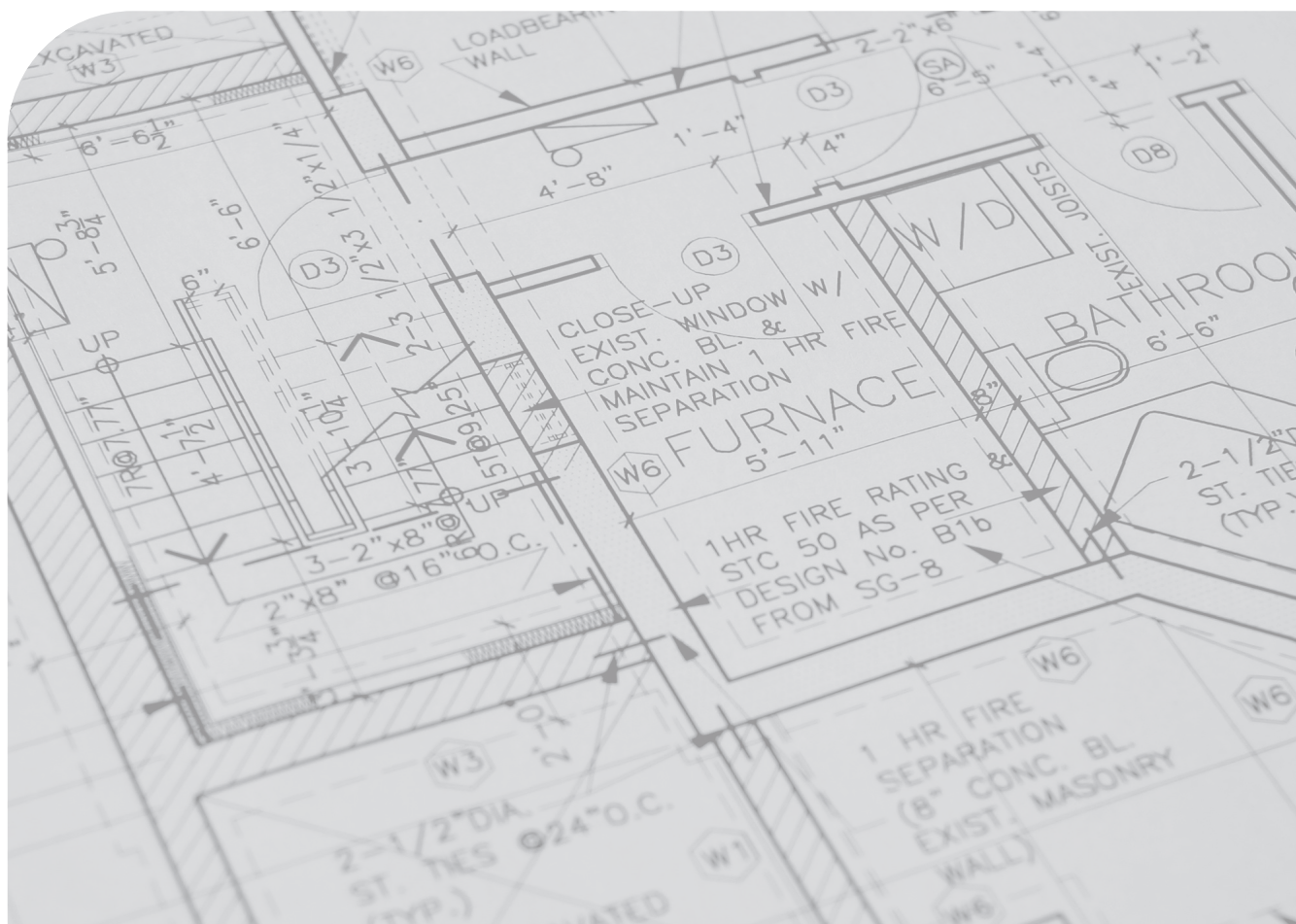

INDEX

Dear Customer.....	3
Safety symbols used.....	4
Disposal Method	4
General Warnings.....	4
1 Remote Control Specifications.....	5
1.1 Quick Guide.....	5
1.2 Activation.....	6
1.3 Functions and Keys.....	7
1.4 Indicators on the Display	8
1.5 Basic functions	9
1.6 Advanced functions.....	10
1.6.1 SET function.....	10
1.6.2 ECO\GEAR function.....	10
1.6.3 SWING Function.....	10
1.6.4 TURBO Function	11
1.6.5 LED Function.....	11
1.6.6 LOCK Function.....	11
1.6.7 SILENCE Function	11
1.6.8 FP Function (Antifreeze Protection).....	11
1.6.9 CLEAN function.....	11
1.6.10 Switching TIMER on/off.....	11



DEAR CUSTOMER

Congratulations for having chosen a top-quality Immergas product, able to assure well-being and safety for a long period of time. As an Immergas Customer, you can also count on a qualified Authorised Technical After-Sales Centre, prepared and updated to guarantee constant efficiency of your product. Read the following pages carefully: you will be able to draw useful tips on the proper use of the device, compliance with which will confirm your satisfaction with the Immergas product.

For assistance and routine maintenance, contact Authorised Technical Service Centres: they have original spare parts and are specifically trained directly by the manufacturer.

The company **IMMERGAS S.p.A.**, with registered office in via Cisa Ligure 95 42041 Brescello (RE), declares that the design, manufacturing and after-sales assistance processes comply with the requirements of standard **UNI EN ISO 9001:2015**.

For further details on the product CE marking, request a copy of the Declaration of Conformity from the manufacturer, specifying the appliance model and the language of the country.

The manufacturer disclaims all liability due to printing or transcription errors, reserving the right to make any modifications to its technical and commercial documents without forewarning.





GENERAL WARNINGS

This booklet contains important information:

- The user must carefully read the instructions provided.
- The user must limit operations on the appliance only to those explicitly allowed.
- The instruction booklet is an integral and essential part of the product and must be given to the new user in the case of transfer or succession of ownership.
- It must be stored with care and consulted carefully, as all of the warnings provide important safety indications for installation, use and maintenance stages.
- All Immergas products are protected with suitable transport packaging.
- The material must be stored in a dry place protected from the weather.
- The appliance must only be destined for the use for which it has been expressly intended. Any other use will be considered improper and therefore potentially dangerous.
- In the event of malfunctions, faults or incorrect operation, contact an authorised company (e.g. the Authorised Technical Assistance Centre, which has specifically trained staff and original spare parts). Do not attempt to modify or repair the appliance alone.

SAFETY SYMBOLS USED



GENERIC HAZARD

Strictly follow all of the indications next to the pictogram. Failure to follow the indications can generate hazard situations resulting in possible serious harm to the health of the operator and user in general, and/or serious material damage.



WARNINGS

Strictly follow all of the indications next to the pictogram. Failure to follow the indications can generate hazard situations resulting in possible minor injuries to the health of the operator and user in general, and/or minor material damage.



ATTENTION

Read and understand the appliance's instructions before performing any operation, carefully following the indications provided. Failure to follow the indications can generate appliance malfunctions.



INFORMATION

Indicates useful tips or additional information.

DISPOSAL METHOD



This marking on the product means that waste electrical and electronic equipment must not be mixed with generic household waste.

Do not dispose of this product as unsorted city waste. Incorrect management of waste has potential negative effects on the environment and on human health.

To dispose of the device, refer to waste electrical and electronic equipment collection centres or contact the dealer that you purchased it from.

Discharged batteries must be taken out of the remote controls and disposed of separately in compliance with local regulations.



1 REMOTE CONTROL SPECIFICATIONS

1.1 QUICK GUIDE

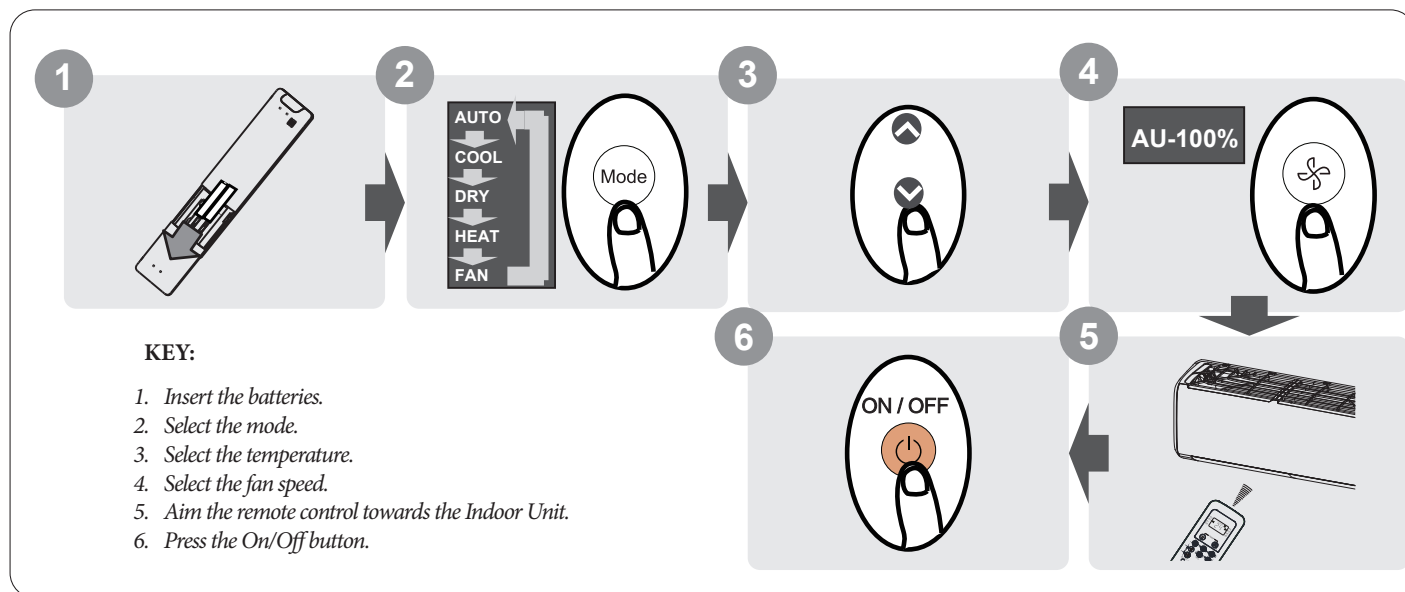

Model

Model	RG10A - (UI THOR - CAS- CONS - SP)
	RG10A1 - (UI GOTH A)
Rated Voltage	3,0V (2 batteries 1.5V LR03 - AAA)
Signal reception area	8 m
Environmental conditions	-5 °C ~ 60 °C



1.2 ACTIVATION

The air conditioner remote control comes with two LR03 - AAA batteries.

1. Slide the rear cover of the remote control downwards to reach the battery compartment.
2. Insert the batteries in the specific compartment, making sure that the poles (+) and (-) of the batteries match the symbols inside the battery compartment.
3. Put the cover back on, sliding it in the specific slot.

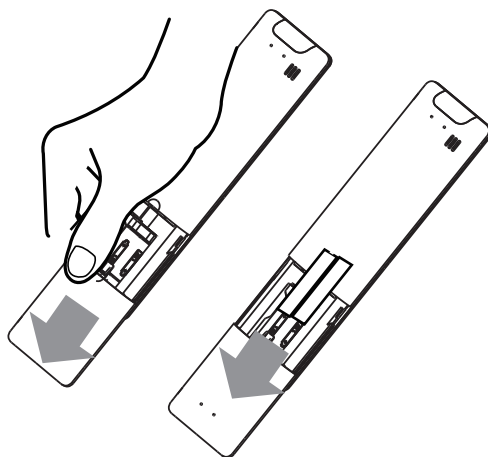

ATTENTION

- The remote control must be used at a maximum distance of 8 m from the indoor unit aiming towards the receiver.
- The unit beeps confirming to have received the signal.
- Curtains, other materials and direct sunlight can interfere with the infrared signal receiver.
- Remove the batteries when not using the remote control for over 2 months.

NOTE:

To achieve best performance of the product:

- Do not mix old and new batteries or batteries of different types.
- If the device is not used for over 2 months, remove the batteries from the remote control.

NOTE:

The manufacturer Immergas declares that the device complies with Directive 2014/53/EU

This appliance generates, uses and can irradiate radiofrequency energy and, if it not installed and used according to the instructions, can cause harmful interference with radio communications. Nonetheless, there is no guarantee that interference does not occur in a particular installation. If this appliance causes harmful interference to radio or television reception, which can be determined by switching the appliance off and back on, the user is encouraged to try to correct the interference by taking one or more of the following measures:

- Direct or reposition the reception antenna differently.
- Move the appliance and receiver further apart.
- Connect the appliance to a socket on a different circuit than that which the receiver is connected to.
- Seek the assistance of a radio/TV dealer or technician.
- Changes or modifications not approved by those in charge could cause the user to lose the right to use the device.



1.3 FUNCTIONS AND KEYS

NOTE:

- The keys of your remote control could be slightly different from those depicted in example shown.
- If the air conditioner does not have a particular function, pressing the key for that function will have no effect.

Before using the air conditioner, we recommend reading the instructions of the remote control. A brief introduction follows. See the following chapters in this manual for instructions on the functions of the air conditioner.

KEY:

1. ON \ OFF : Switch the Indoor Unit on or off.
2. TEMP \wedge : Increase the temperature at 1°C steps (maximum temperature 30°C).
3. SET: Select the operating functions, such as:
 - Sleep
 - FollowMe
 - ApMode
4. TEMP \vee : Decrease the temperature at 1°C steps (minimum temperature 16°C).
5. FAN SPEED: Select the fan speed in the following order:
 - AU 20%
 - 40%
 - 60%
 - 80%
 - 100%
6. TURBO: Allows the unit to reach the set temperature in as short a time as possible.
7. LED: Activates and deactivates the LED display on the indoor unit and the buzzer on the air conditioner.
8. MODE: Goes to the next mode according to the following order;
 - Auto
 - Cool
 - Drying
 - Heat
 - Fan
9. ECO\GEAR: To access energy-saving mode according to the following sequence:
 - Eco
 - Gear (75%)
 - Gear (50%)
 - Previous ECO setting mode.
10. OK: Pressed to confirm the selected functions
11. TIMER: To set the automatic starting time to activate or deactivate the unit
12. SWING: Activates and deactivates movement of the horizontal deflector.
13. INDIRECT AIR FLOW: Function only available in COOL, FAN or DRY mode.
13. FRESH: To purify the air in the room through ionisation (ONLY FOR UI GHOTHA MODELS).
14. CLEAN: Activates/deactivates the Automatic Cleaning function.

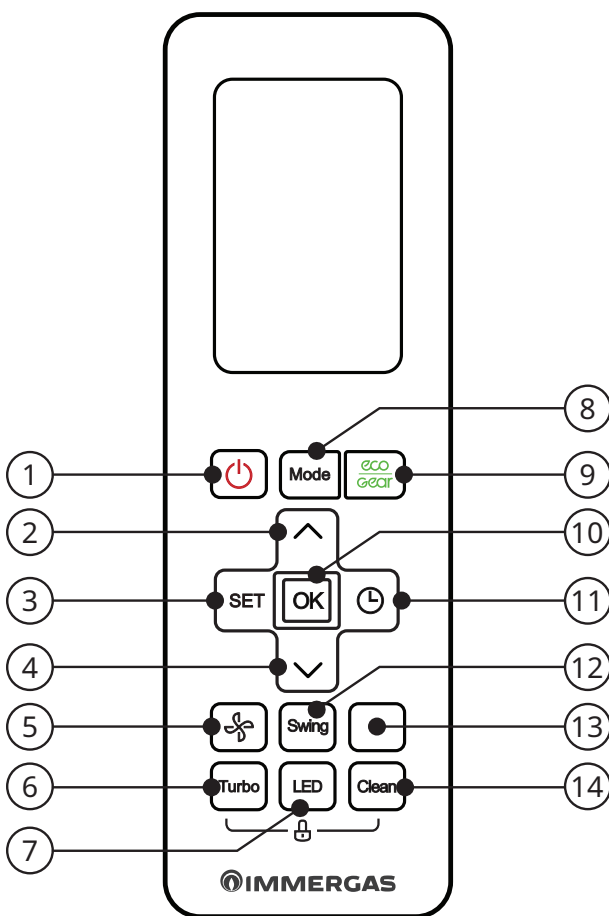

NOTE:

- Holding down keys TEMP \wedge and TEMP \vee simultaneously for 3 seconds, toggles the temperature unit of measurement between °C and °F.
- Pressing keys TEMP \wedge or TEMP \vee increases or lowers fan speed.



1.4 INDICATORS ON THE DISPLAY

The following information is displayed when the remote control is switched on.

NOTE:

- All of the icons shown in the figure below are for illustrative purposes only.
- During actual use, the display will only show the relative function icons.

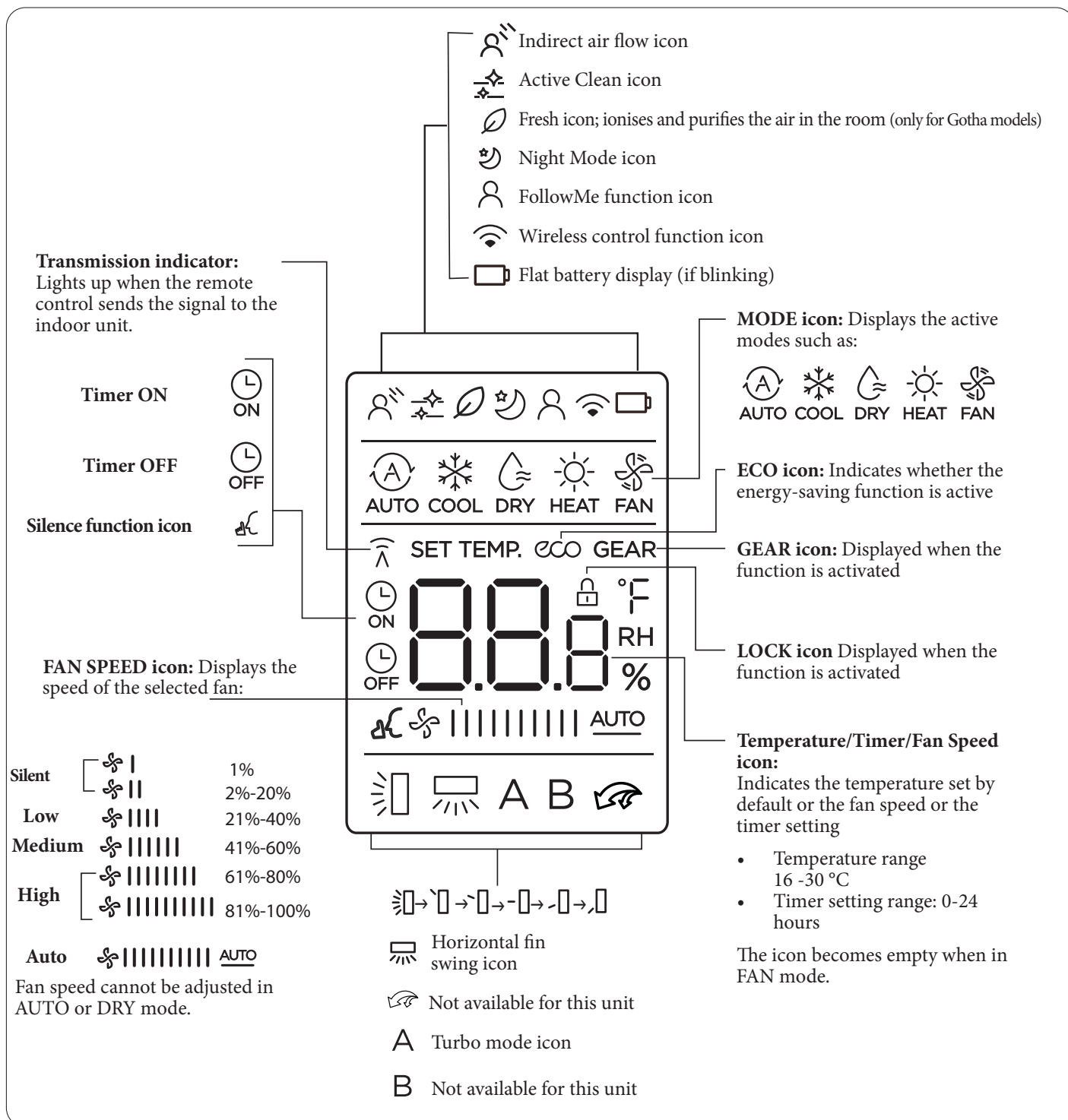

1.5 BASIC FUNCTIONS



Attention:
Before use, make sure that the unit is powered up.

NOTE ON TEMPERATURE SETTING:

The operating temperature range for the units is 16 - 30°C / 20 - 28°C. The set temperature can be increased or decreased with 1°C steps.

AUTO mode:



In AUTO mode, the unit will automatically select the COOL, FAN or HEAT function based on the set temperature.

1. Press the MODE key to select AUTO.
2. Press TEMP \wedge or TEMP \vee to set the desired temperature.
3. Press the ON/OFF key to start the unit.

COOL mode:

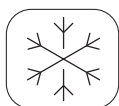

1. Press the MODE key to select COOL mode.
2. Press TEMP \wedge or TEMP \vee to set the desired temperature.
3. Press the FAN key to select fan speed between AU and 100%.
4. Press the ON/OFF key to start the unit.

DRY mode:



1. Press the MODE key to select DRY.
2. Press TEMP \wedge or TEMP \vee to set the desired temperature.
3. Press the ON/OFF key to start the unit.

HEAT mode:

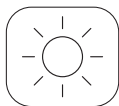

1. Press the MODE key to select HEAT mode.
2. Press TEMP \wedge or TEMP \vee to set the desired temperature.
3. Press the FAN key to select fan speed between AU and 100%.
4. Press the ON/OFF key to start the unit.

FAN mode:



1. Press the MODE key to select FAN mode.
2. Press the FAN key to select fan speed between AU and 100%.
3. Press the ON/OFF key to start the unit.

NOTE:

- FAN SPEED cannot be set in AUTO mode.
- FAN SPEED cannot be set in DRY mode.
- The temperature cannot be set in FAN mode. Thereby the LCD screen of the remote control will not display the temperature.



Attention:
When the outdoor temperature drops, the heating performance of the unit could be affected. In these cases, it is recommended to use this air-conditioner in combination with other heating appliances.



1.6 ADVANCED FUNCTIONS

1.6.1 SET FUNCTION



1. Press the SET key to access the setting of the function, then press the SET key or the TEMP \wedge or TEMP \vee key to select the required function. The selected symbol will flash in the area of the display, press OK to confirm.
2. To cancel the selected function, simply perform the same procedures as above.
3. Press the SET key to scroll the functions in the following order: Sleep \rightarrow Follow Me \rightarrow AP Mode

- **SLEEP function:**

Activating it reduces energy consumption. If in HEAT mode, the air conditioner lowers the temperature by 1°C for each hour of operation, up to a maximum of 2°C, and vice versa in COOL mode. Function can only be activated with the remote control.

- **FOLLOW ME function:**

The FOLLOW ME function allows the remote control to detect the temperature of the room where it is located and to send this signal to the air conditioner every 3 minutes. When using the AUTO, COOL or HEAT functions, detection of the room temperature by the remote control (instead of by the indoor unit) allows the air conditioner to optimise room temperature and guarantee maximum comfort.

- **AP function (in some units):**

Choose the AP mode to configure the wireless network. For some units, it is not active by pressing the SET key. To access AP mode, press the LED button seven times in 10 seconds.



- The unit can be remotely controlled (standard function only in Gotha models, optional on all others) through the CLIMA SMART app after having activated the AP function. Refer to the dedicated "SMART KIT WI-FI" manual for details.

NOTE:

1. The SLEEP function is not available in FAN or DRY mode.
 2. Hold down the "Turbo" key for seven seconds to start/stop storage of the Follow me function.
 - When the memory function is activated, "On" will be displayed on the screen for 3 seconds. Pressing the ON/OFF key, changing mode or switching off power will not cancel the Follow Me function.
 - When the memory function is interrupted, "OFF" will be displayed on the screen for 3 seconds.
-

1.6.2 ECO\GEAR FUNCTION



Pressing ECO\GEAR activates energy-saving mode, displaying the following sequence: ECO \rightarrow GEAR(75%) \rightarrow GEAR(50%) \rightarrow Previous setting mode \rightarrow ECO.

- **ECO function:**

In COOL mode, by pressing ECO\GEAR the remote control will automatically adjust the speed and temperature at 24°C, to save energy.

If the set temperature is higher than 24°C, pressing ECO will switch the fan speed to Auto and the set temperature will remain unchanged.

Pressing ECO/GEAR, modifying the mode or adjusting the set temperature lower than 24 °C will interrupt the ECO/GEAR operation.

In ECO/GEAR mode the temperatures should be set at 24 °C or higher, possibly causing insufficient cooling. If the cooling capacity is insufficient, press ECO/GEAR again to deactivate this function.

- **GEAR function:**

1. 75% (up to 75% of power consumption) \rightarrow
2. 50% (up to 50% of power consumption) \rightarrow
3. Previously set mode.

NOTE: The ECO function is only available in COOL mode

1.6.3 SWING FUNCTION

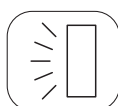

1. By pressing the Swing key, the horizontal deflector will automatically swing up and down.
2. Press the Swing key again to stop the deflector.
3. Continuous pressing of the SWING key can set five different air flow inclinations.
4. The Vertical deflector must be directed manually on Thor and Gotha models.

NOTE: Holding down the Swing key for over 2 seconds activates the swing function of the vertical deflector only (this function is specific only for certain units).



1.6.4 TURBO FUNCTION



1. By pressing the Turbo key with COOL mode active, the indoor unit will emit cold air at maximum power to quickly start the cooling process.
2. By pressing the Turbo key with HEAT mode active, the indoor unit will emit warm air at maximum power to quickly start the heating process.

1.6.5 LED FUNCTION



1. Press the LED key to switch the indoor unit display on or off.
2. By holding down this key for over 5 seconds, the indoor unit will display the actual room temperature. By holding down the LED key again for over 5 seconds, the display will go back to the set temperature.

1.6.6 LOCK FUNCTION



The keys will not respond when this function is activated.

1. To activate the Lock function, hold down the Turbo and Clean keys simultaneously for at least 5 seconds.
2. To unlock, press the two keys again for at least two seconds.

1.6.7 SILENCE FUNCTION



Hold down the FAN key for over 2 seconds to activate or deactivate the Silence function.

Due to the low frequency operation of the compressor, cooling or heating performance could be reduced. To cancel the Silence function, press ON/OFF, Mode, Sleep, Turbo or Clean during operation.

1.6.8 FP FUNCTION (ANTIFREEZE PROTECTION)



The unit will operate at maximum fan speed (with compressor on) with temperature set automatically at 8°C.

1. Activate the HEAT mode, set the temperature at 16 °C.
2. Press TEMP ∨ twice in one second to activate the FP function.
3. Pressing On/Off, MODE, Fan or TEMP will deactivate the FP function.

NOTE: This function can only be activated in HEAT mode.

1.6.9 CLEAN FUNCTION



Bacteria in the air can be promoted by the humidity which can be generated around the internal battery. The majority of this humidity is eliminated with regular use of the unit. Pressing the CLEAN key, the unit would clean itself automatically.

1. After cleaning, the unit automatically switches off.
2. Pressing the CLEAN key at mid-cycle cancels the operation and switches off the unit.
3. You may activate the CLEAN function as many times as you wish.

NOTE: This function can only be activated in COOL or DRY mode.

1.6.10 SWITCHING TIMER ON/OFF



Sets the time range, in hours, at the end of which the air conditioner automatically switches on/off.

The time periods set for both timer functions refer to the hours *following* the current hour.

1. Press the TIMER key to start the ON or OFF time sequence.
2. Press the Temp up and down keys several times to set the time you want the unit to switch on.
3. Aim the remote control towards the unit and wait 1 second, TIMER ON or TIMER OFF will be activated.

NOTE:

- While setting TIMER ON or TIMER OFF, every time the key is pressed automatically postpones the starting time by 30 minutes, up to a maximum of 10 hours. Beyond 10 hours, and up to 24 hours, the time is postponed by 60 minutes at every press. (For example, pressing 5 times sets the time at 2.5 hours, pressing 10 times at 5 hours). The timer resets at 0.0 after 24 hours.
- Setting the timer at 0.0 hours deactivates this function.



Immergas S.p.a.

42041 Brescello (RE) - Italy

Tel. 0522.689011

immergas.com



This instruction booklet is made
of ecological paper.

